

LIMITED EDITION Luggage Rack Manual 2016



1. Loosen the side brackets with an inbus tool.
2. Place the luggage rack on the boot-lid and position it in the middle.

3. When you think the luggage rack is in the correct position. Use tape to mark the position of the carrier on the boot-lid. Take the luggage rack off the decklid and apply the 3M foil on the edge of the decklid



4.

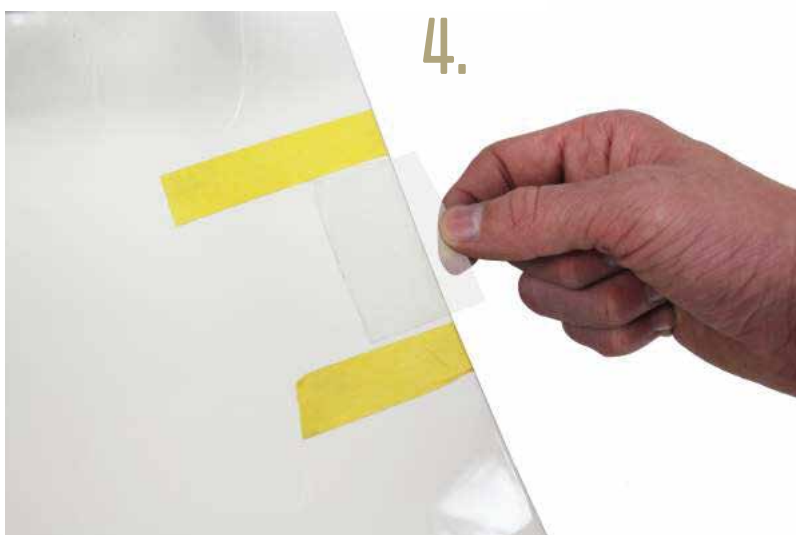

5. Take out the plastic plug.



6. Place the luggage rack on the boot-lid and tighten the side brackets.



7. Use the supplied two screws on every bracket for extra security. Don't tighten these screws with too much force because they can go through the protective 3-M foil.



8. Be aware! When you close the decklid be sure the brackets don't touch the car.

If the brackets touch the side panels the carrier is in the wrong position.

